

These 2 need to be concentric to the axis--no more than .001 out!

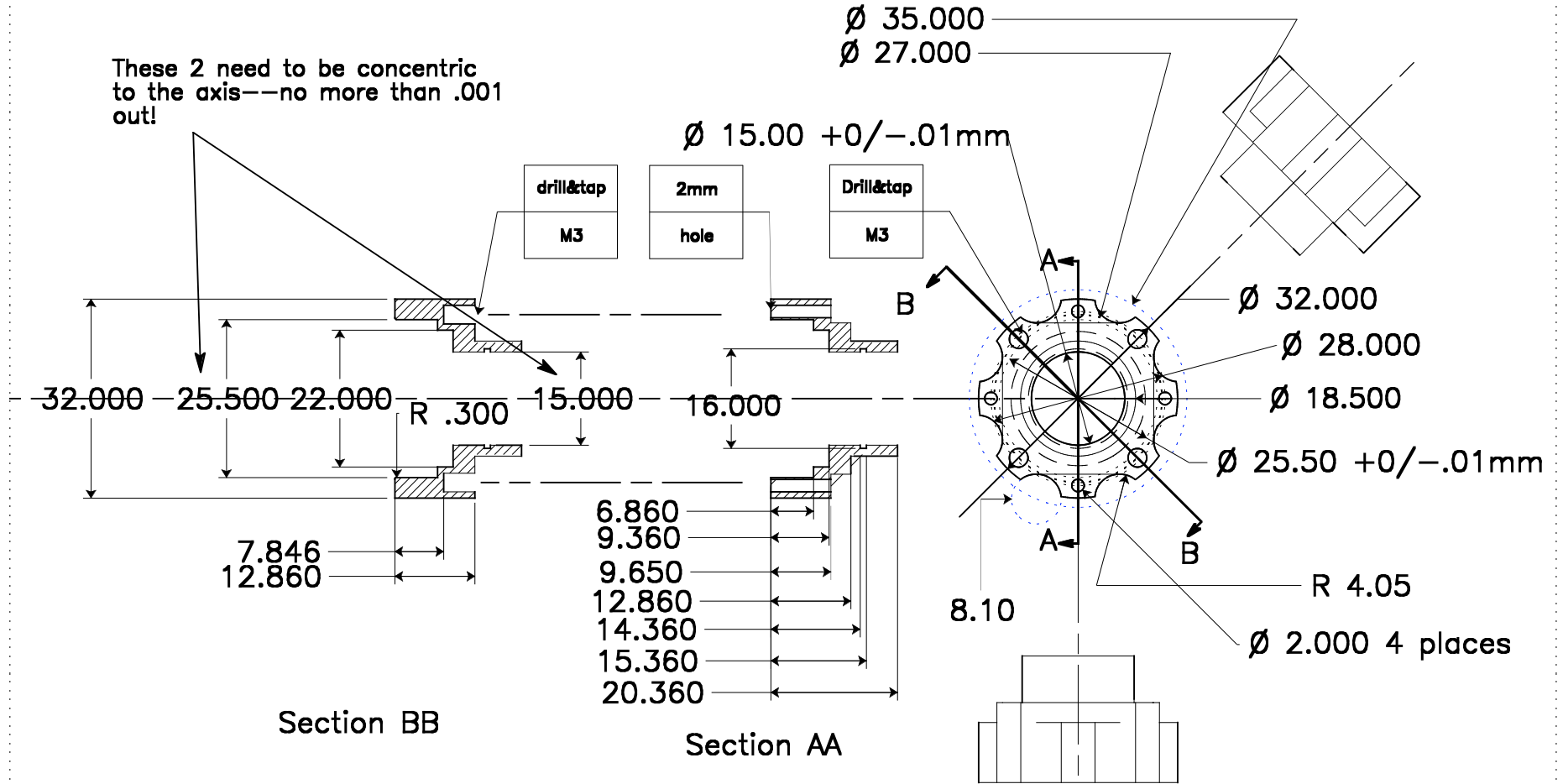

Section BB

Section AA

- 1)Material:6061 AL
- 2)Finish : as machined-Black Anodized
- 3)Remove burrs
- 4) +/- .05mm on all dimensions except as noted

- 1)Blue lines and numbers are to help make layout clearer
- 2) added missing dimensions and other small changes

					Name	Date	Title		
				Created By	SWN	240706	15XX IMS gear housing		
				Checked By			Rev3		
				Scale			Drawing Number	Issue	
				Neutronics INC					
No	Change	Date	Init						